

Oblúky SW ASME B16.11

Oblúk 90°

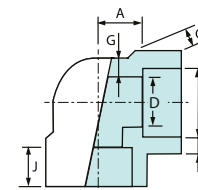

Oblúk 45°

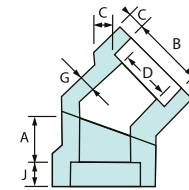

Rozmery	J min	B	C min		A				Váha (kg/ks)			
					90°		45°		90°		45°	
			3000 lbs	6000 lbs	3000 lbs	6000 lbs	3000 lbs	6000 lbs	3000 lbs	6000 lbs	3000 lbs	6000 lbs
1/4"	10	14,35	3,3	4,0	11	13,5	8	8	0,1	0,18	0,09	0,15
3/8"	10	17,78	3,5	4,4	13,5	15,5	8	11	0,13	0,31	0,11	0,29
1/2"	10	21,97	4,1	5,2	15,5	19	11	12,5	0,24	0,46	0,2	0,4
3/4"	13	27,31	4,3	6,0	19	22,5	13	14	0,34	0,73	0,28	0,65
1"	13	34,04	5,0	7,0	22,5	27	14	17,5	0,51	1,13	0,44	0,96
1 1/4"	13	42,80	5,3	7,0	27	32	17,5	20,5	0,77	1,5	0,65	1,3
1 1/2"	13	48,90	5,5	7,8	32	38	20,5	25,5	1,03	2,59	0,84	2,2
2"	16	61,37	6,0	9,5	38	41	25,5	28,5	1,59	3,47	1,3	3,01
2 1/2"	16	74,07	7,7		41		28,5		2,79		2,5	
3"	16	90,04	8,3		57		32		4,8		4,15	
4"	19	115,20	9,3		66,5		41		14,5		12,5	

ADRESA

N+F Slovakia, s.r.o.
Areál Slovnaft, a.s.
Budova ABIII
Vlčie hrdlo 1
824 12 Bratislava

KONTAKT

Tel: + 421 2 4055 2570-1
E-mail: nuf@nuf.eu

FAKTURAČNÉ ÚDAJE

N+F Slovakia, s.r.o.
Vlčie hrdlo 1
824 12 Bratislava
IČO: 45 254 273
IČ DPH: SK2022913849

Typ 1

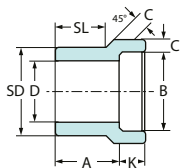

Typ 2

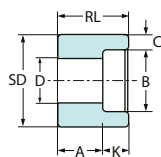

Redukované vsuvky SW podľa MSS SP 79

Rozmery	Typ		B	K min	SD	A		D		C min		SL		RL min	
	3000 lbs	6000 lbs				3000 lbs	6000 lbs	3000 lbs	6000 lbs	3000 lbs	6000 lbs	3000 lbs	6000 lbs	3000 lbs	6000 lbs
3/8" x 1/4"	1	1	14,35	10	17,15	19	21	9,0	6,5	3,78	4,60	14	16		
1/2" x 3/8"	1	1	17,78	10	21,34	21	23	12,5	9,0	4,01	5,03	16	16		
1/2" x 1/4"	1	1	14,35	10	21,34	21	21	9,0	6,5	3,78	4,60	16	16		
3/4" x 1/2"	1	1	21,97	10	26,67	22	25	16,0	11,5	4,67	5,97	17	19		
3/4" x 3/8"	2	1	17,78	10	26,67	16	22	12,5	9,0	4,01	5,03		19	27	
3/4" x 1/4"	2	2	14,35	10	26,67	18	22	9,0	6,5	3,78	4,60			27	32
1" x 3/4"	1	1	27,31	13	33,40	24	28	21,0	15,5	4,90	6,96	19	21		
1" x 1/2"	2	1	21,97	10	33,40	16	28	16,0	11,5	4,67	5,97		21	28	
1" x 3/8"	2	2	17,78	10	33,40	18	22	12,5	9,0	4,01	5,03			28	33
1" x 1/4"	2	2	14,35	10	33,40	19	24	9,0	6,5	3,78	4,60			28	33
1 1/4" x 1"	1	1	34,04	13	42,16	25	30	26,5	20,5	5,69	7,92	21	22		
1 1/4" x 3/4"	2	2	27,31	13	42,16	18	21	21,0	15,5	4,90	6,96			32	35
1 1/4" x 1/2"	2	2	21,97	10	42,16	19	22	16,0	11,5	4,67	5,97			32	35
1 1/4" x 3/8"	2	2	17,78	10	42,16	21	24	12,5	9,0	4,01	5,03			32	35
1 1/4" x 1/4"	2	2	14,35	10	42,16	22	25	9,0	6,5	3,78	4,60			32	35
1 1/2" x 1 1/4"	1	1	42,80	13	48,26	28	35	35,0	29,5	6,07	7,92	22	25		
1 1/2" x 1"	2	1	34,04	13	48,26	18	29	26,5	20,5	5,69	7,92		25	33	
1 1/2" x 3/4"	2	2	27,31	13	48,26	19	25	21,0	15,5	4,90	6,96			33	40
1 1/2" x 1/2"	2	2	21,97	10	48,26	21	27	16,0	11,5	4,67	5,97			33	40
1 1/2" x 3/8"	2	2	17,78	10	48,26	22	28	12,5	9,0	4,01	5,03			33	40
2" x 1 1/2"	1	1	48,90	13	60,32	32	39	41,0	34,0	6,35	8,90	25	28		
2" x 1 1/4"	2	2	42,80	13	60,32	21	24	35,0	29,5	6,07	7,92			38	41
2" x 1"	2	2	34,04	13	60,32	22	25	26,5	21,0	5,69	7,92			38	41
2" x 3/4"	2	2	27,31	13	60,32	24	27	21,0	15,5	4,90	6,96			38	41
2" x 1/2"	2	2	21,97	10	60,32	25	28	16,0	11,5	4,67	5,97			38	41
2 1/2" x 2"	1	1	61,37	16	73,02	46	43	52,5	43,0	6,93	10,92	38	32		
2 1/2" x 1 1/2"	2	2	48,90	13	73,02	35	x	41,0	x	6,35	x			54	x
2 1/2" x 1 1/4"	2	2	42,80	13	73,02	37	x	35,0	x	6,07	x			54	x
2 1/2" x 1"	2	2	34,04	13	73,02	38	x	26,5	x	5,69	x			54	x
2 1/2" x 3/4"	2	2	27,31	13	73,02	40	x	21,0	x	4,90	x			54	x
3" x 2 1/2"	1	x	74,07	16	88,90	38	x	62,5	x	8,76	x	32	x		

Uvedené rozmery (v mm) a hmotnosti (kg/ks) slúžia len na informatívne účely.



Redukované vsuvky SW podľa MSS SP 79

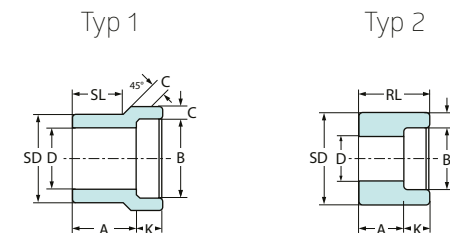

Rozmery	Typ		B	K min	SD	A		D		C min		SL		RL min	
	3000 lbs	6000 lbs				3000 lbs	6000 lbs	3000 lbs	6000 lbs	3000 lbs	6000 lbs	3000 lbs	6000 lbs	3000 lbs	6000 lbs
3" x 2"	2	x	61,37	16	88,90	25	x	52,5	x	6,93	x			48	x
3" x 1 1/2"	2	x	48,90	13	88,90	29	x	41	x	6,35	x			48	x
3" x 1 1/4"	2	x	42,80	13	88,90	30	x	35	x	6,07	x			48	x
3" x 1"	2	x	34,04	13	88,90	32	x	27	x	5,69	x			48	x
4" x 3"	2	x	90,04	16	114,30	33	x	78	x	9,50	x			60	x
4" x 2 1/2"	2	x	74,07	16	114,30	38	x	63	x	8,76	x			60	x
4" x 2"	2	x	61,37	16	114,30	38	x	53	x	6,93	x			60	x
4" x 1 1/2"	2	x	48,90	13	114,30	42	x	41	x	6,35	x			60	x
4" x 1 1/4"	2	x	42,80	13	114,30	43	x	35	x	6,07	x			60	x

ADRESA

N+F Slovakia, s.r.o.
Areál Slovnaft, a.s.
Budova ABIII
Vlčie hrdlo 1
824 12 Bratislava

KONTAKT

Tel: + 421 2 4055 2570-1
E-mail: nuf@nuf.eu

FAKTURAČNÉ ÚDAJE

N+F Slovakia, s.r.o.
Vlčie hrdlo 1
824 12 Bratislava
IČO: 45 254 273
IČ DPH: SK2022913849

T-kusy a kríže SW ASME B16.11

T-kus SW

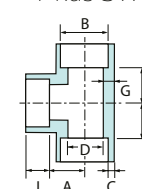

Kríž SW

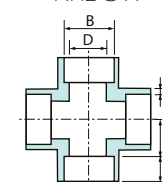

Rozmery	J min	B	C min		A		Váha (kg/ks)			
					T-kusy a kríže		T-kusy		Kríže	
			3000 lbs	6000 lbs	3000 lbs	6000 lbs	3000 lbs	6000 lbs	3000 lbs	6000 lbs
1/4"	10	14,35	3,3	4,0	11	13,5	0,16	0,23	0,19	
3/8"	10	17,78	3,5	4,4	13,5	15,5	0,17	0,48	0,27	0,55
1/2"	10	21,97	4,1	5,2	15,5	19	0,32	0,62	0,39	0,77
3/4"	13	27,31	4,3	6,0	19	22,5	0,45	0,99	0,56	1,28
1"	13	34,04	5,0	7,0	22,5	27	0,7	1,51	0,84	1,96
1 1/4"	13	42,80	5,3	7,0	27	32	0,99	2,03	1,23	2,6
1 1/2"	13	48,90	5,5	7,8	32	38	1,29	3,42	1,66	4,5
2"	16	61,37	6,0	9,5	38	41	2,1	4,5	2,64	5,95
2 1/2"	16	74,07	7,7		41		3,72		5,1	
3"	16	90,04	8,3		57		6,25		8,05	
4"	19	115,20	9,3		66,5		18,5		23	

Dná SW ASME B16.11

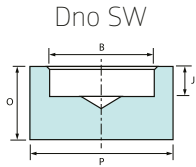

Rozmery	J min	B	3000 lbs			6000 lbs		
			O	P	Váha (kg/ks)	O	P	Váha (kg/ks)
1/4"	10	14,35	20	22	0,06	20	26	0,09
3/8"	10	17,78	20	26	0,08	20	28	0,16
1/2"	10	21,97	20	32	0,12	22	35	0,19
3/4"	13	27,31	24	38	0,16	25	45	0,28
1"	13	34,04	27	45	0,25	28	50	0,59
1 1/4"	13	42,80	27	55	0,43	28	60	0,77
1 1/2"	13	48,90	28	63	0,55	30	65	1,09
2"	16	61,37	33	75	0,93	36	85	1,55
2 1/2"	16	74,07	36	95	1,43	39	100	2,57
3"	16	90,04	40	110	2,31	44	120	3,53
4"	19	115,20	45	140	4,20	51	150	6,30

Halfcoupling

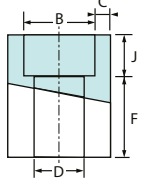

Coupling

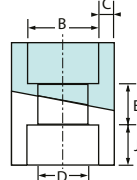

Nátrubky SW ASME B16.11

Rozmery	J min	B	C min		Coupling	Half Coupling	Váha (kg/ks)			
			3000 lbs	6000 lbs			Coupling		Half Coupling	
					E	F	3000 lbs	6000 lbs	3000 lbs	6000 lbs
1/4"	10	14,35	3,3	4,0	6,5	16	0,07	0,11	0,07	0,14
3/8"	10	17,78	3,5	4,4	6,5	17,5	0,09	0,21	0,1	0,23
1/2"	10	21,97	4,1	5,2	9,5	22,5	0,14	0,29	0,16	0,35
3/4"	13	27,31	4,3	6,0	9,5	24	0,2	0,4	0,23	0,45
1"	13	34,04	5,0	7,0	12,5	28,5	0,34	0,72	0,38	0,8
1 1/4"	13	42,80	5,3	7,0	12,5	30	0,49	0,95	0,63	1,08
1 1/2"	13	48,90	5,5	7,8	12,5	32	0,66	1,35	0,8	1,52
2"	16	61,37	6,0	9,5	19	41	1,04	2,24	1,24	2,55
2 1/2"	16	74,07	7,7		19	43	1,7	3,13	1,9	3,61
3"	16	90,04	8,3		19	44,5	2,15	4,2	2,45	5
4"	19	115,20	9,3		19	48	3,61	7,5	4,16	8,5

Uvedené rozmery (v mm) a hmotnosti (kg/ks) slúžia len na informatívne účely.

Redukované nátrubky SW ASME B16.11

Redukovaný nátrubok SW

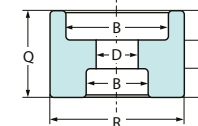

Rozmery	3000 lbs			6000 lbs		
	Q	R	Váha (kg/ks)	Q	R	Váha (kg/ks)
3/8" x 1/4"	25	26	0,04	25	28	
1/2" x 3/8"	28	32	0,06	28	35	0,10
1/2" x 1/4"	28	32	0,06	28	35	0,10
3/4" x 1/2"	31	38	0,10	31	45	0,25
3/4" x 1/4"	31	38	0,10	31	45	0,25
1" x 3/4"	37	45	0,18	37	50	0,35
1" x 1/2"	34	45	0,18	34	50	0,35
1" x 1/4"	34	45	0,18	34	50	0,35
1 1/4" x 1"	37	55	0,30	37	60	0,44
1 1/2" x 1"	37	63	0,40	38	65	0,70
1 1/2" x 3/4"	37	63	0,40	38	65	0,70
1 1/2" x 1/2"	34	63	0,40	38	65	0,70
2" x 1 1/2"	46	75	0,60	51	85	1,00
2" x 1"	46	75	0,60	51	85	1,00

ADRESA

N+F Slovakia, s.r.o.
 Areál Slovnaft, a.s.
 Budova ABIII
 Vlčie hrdlo 1
 824 12 Bratislava

KONTAKT

Tel: + 421 2 4055 2570-1
 E-mail: nuf@nuf.eu

FAKTURAČNÉ ÚDAJE

N+F Slovakia, s.r.o.
 Vlčie hrdlo 1
 824 12 Bratislava
 IČO: 45 254 273
 IČ DPH: SK2022913849

Šróbenie SW

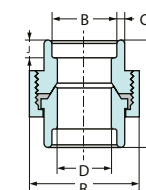

Šróbenia SW MSS SP 83 - BS 3799

Rozmery	J min	B	3000 lbs			6000 lbs		
			Q	R	Váha (kg/ks)	Q	R	Váha (kg/ks)
1/4"	10	14,35	42,5	36,0	0,30			
3/8"	10	17,78	51,0	41,0	0,39			
1/2"	10	21,97	57,0	46,0	0,52	57	56	1,43
3/4"	13	27,31	57,0	56,0	0,70	63	65	1,87
1"	13	34,04	63,0	64,5	1,10	71	80	2,24
1 1/4"	13	42,80	68,0	80,0	1,36	76	87	2,87
1 1/2"	13	48,90	77,0	87,0	1,94	89	100	4,10
2"	16	61,37	92,0	100,0	2,87	118	125	7,15
2 1/2"	16	74,07	118,0	125,0	6,60			
3"	16	90,04	118,0	144,0	8,20			
4"	19	115,20	148,0	200,0	13,00			